

# Automatic Valves



## Shuttle Valve

Tech Sheet  
1854



SCS

0158



SCS 668

G1/8"

20.15

## Non-return Valves

Tech Sheet  
1854



VNR

0158



VNR M5

M5

13.55

VNR 1/8

G1/8"

12.05

VNR 843 07

G1/4"

20.50

## Quick Exhaust Valves

Tech Sheet  
1854

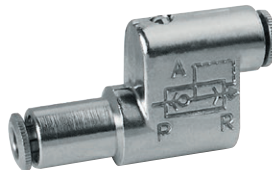

VSO

0158



VSO 426 04

4

10.15

Tech Sheet  
1854



VSC, BSPP

0158



VSC 588

G1/8"

12.30

VSC 544

G1/4"

14.55

VSC 522

G1/2"

22.75

Tech Sheet  
1854



VSO, Standpipe Style

0158



VSO 425 M5

5

10.15

## In-line Flow Control Valves

Tech Sheet  
10307



Uni-directional

0158



RFU 452

M5

15.35

RFU 482

G1/8"

13.85

RFU 483

G1/8"

13.85

RFU 444

G1/4"

22.75

RFU 446

G1/4"

22.75

RFU 429

G1/2"

70.60

Bi-directional

0158



RFO 352

M5

15.35

RFO 382

G1/8"

13.85

RFO 383

G1/8"

13.85

RFO 344

G1/4"

22.75

RFO 346

G1/4"

22.75

For...



Automation

Air Brake Accessories  
C-Truck 9000 Series



...see pages 1098-1103

Hydraulics

Hydraulic  
Quick Release  
Couplings

Pneumatic  
Quick Release  
Couplings

Air Prep.,  
Media, Monitor  
& Test

KELM™  
Pneumatics

Pneumatic  
& Vacuum  
Equipment

Valves

Ring Main  
Systems

Adaptors  
& Fittings

Stainless  
Steel

Malleable  
Iron

Hose,  
Tubing &  
Couplings

Clamps  
& Clips

Sprays &  
Adhesives

Blow Guns,  
Vacuum &  
Nozzles

Pressure Wash,  
Fuelling &  
Lubrication

Air Tools &  
Compressor  
Equipment

Tools,  
Hardware  
& PPE