

VACUUM EJECTORS



Specification

Model	KZH10-B-X185	KZH20-B-X185	KZH30-B-X185	KZH40-B-X185
Body material	Aluminium alloy			
Seal material	NBR			
Passage diameter (mm)	Ø13	Ø21.6	Ø30	Ø42
Fluid	Air			
Supply pressure (MPa)	0-0.7 MPa			
Weight (g)	110	430	970	2000

Ordering Code

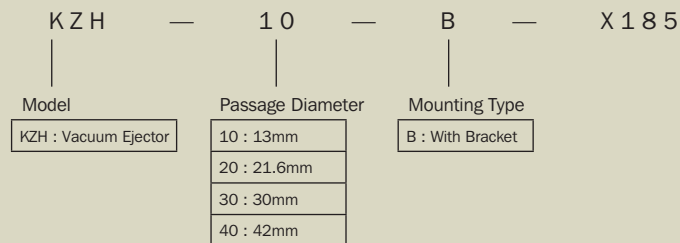

Product Features

- 1 Structure of energy saving three-stage diffuser.
- 2 Compact, large flow.
- 3 20% energy saving.
- 4 Universal mounting.

Dimensions

All sizes are in millimetres unless stated otherwise.

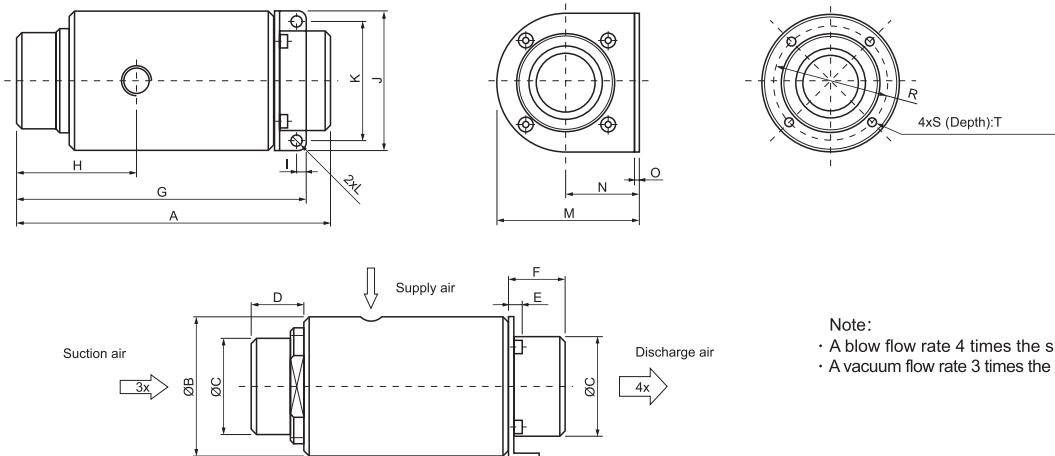

Note:

- A blow flow rate 4 times the supply air
- A vacuum flow rate 3 times the supply air

Model	A	ØB	ØC	D	E	F	G	H	I	J	K	L	M	N	O	P	Q	R	S	T
KZH10-B-X185	73	34	19	10	13.2	16.2	69.8	31	4	35	27	4.5	35	18	1	13	Rc1/8	28	M3x0.5	5
KZH20-B-X185	119.5	55	32	15	19.5	23.5	111	48	4	56	48	4.5	56.5	29	1	21.6	Rc1/4	44	M4x0.7	8
KZH30-B-X185	158	70	50	20	24.5	28.5	146.5	60.5	5	70	60	5.5	72	37	2	30	Rc1/4	59	M4x0.7	10
KZH40-B-X185	203	90	64	25	27.2	33.5	196.8	74.5	6	90	78	5.6	92	47	2.3	42	Rc3/8	76	M4x0.7	10

VACUUM EJECTORS

Flow Characteristics

..... Vacuum pressure - - - Air consumption - - - Suction flow rate — Discharge flow rate

KZH10-B-X185

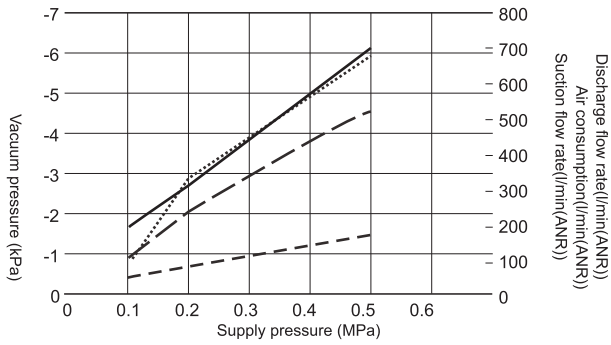

KZH20-B-X185

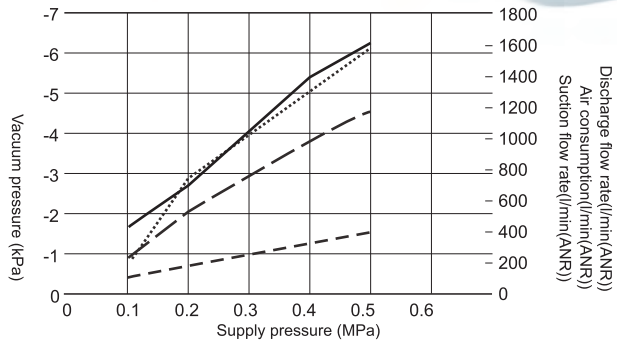

KZH30-B-X185

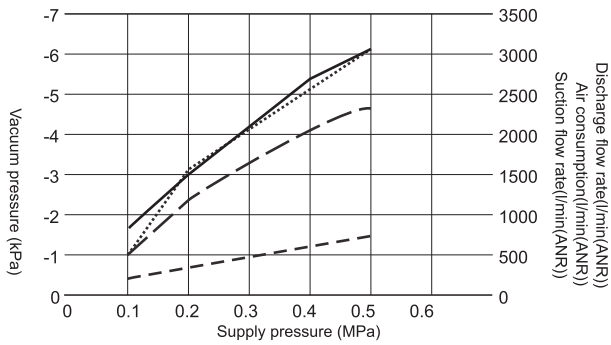

KZH40-B-X185

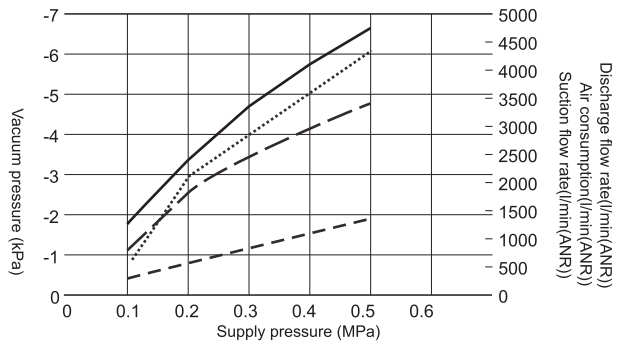

Application

Cooling down aluminium extrusions and plastic

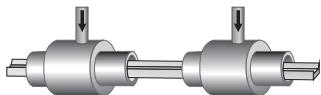

Conveying material

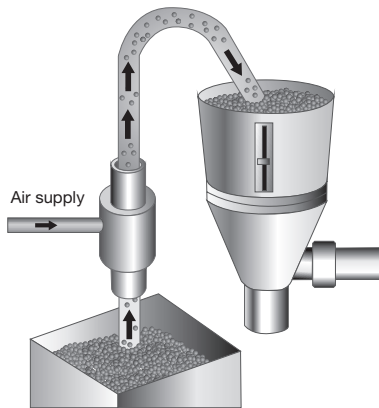

Metal process – suck away flue gas in the CNC lathe

