







VACUUM SAVING VALVES

Specification

Connection thread size for the pad	M5, M6, Ø4			M8, R1/8, Rc1/8, Ø5		
Fixed orifice size (mm)	0.3	0.5	0.7	0.5	0.7	1.0
Fluid	Air					
Max. operating pressure range (mPa)	0 to 0.7					
Max. operating vacuum pressure range (kPa)	0 to -100					
Ambient and fluid temperature (°C)	50 – 60 (no freezing)					
Element nominal filtration rating (µm)	40					
Min. operating flow (l/min (ANR))	3	5	8	5	8	16
Recommended pad diameter (mm)	25 or less			32 to 50		



Ordering Code

K Z P 2 V	—	A 5	—	0 3
 Model		 Type		 Fixed Orifice Size
KZP2V : Vacuum Saving Valve		     		03 : 0.3mm 05 : 0.5mm 07 : 0.7mm 10 : 1.0mm
		A5 : M5 x 0.8 A8 : M8 x 1.25 A01 : R1/8 B5 : M5 x 0.8 B8 : M8 x 1.25 B01 : Rc1/8 A5A5 : M5 x 0.8 A01A01 : R1/8 B5B5 : M5 x 0.8 B01B01 : Rc1/8 A5W4 : M5 x 0.8/Ø4 A01W6 : R1/8/Ø6 B5W4 : M5 x 0.8/Ø4 B01W6 : Rc1/8/Ø6		

Product Features

- 1 Avoids the loss of pressure when there is no workpiece for the vacuum cup.
- 2 No need for the use of sensors when the work pieces are of different sizes, which simplifies the circuit.

VACUUM SAVING VALVES

Dimensions

All sizes are in millimetres unless stated otherwise.

KZP2V-A5-

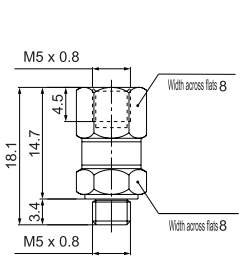

KZP2V-A8-

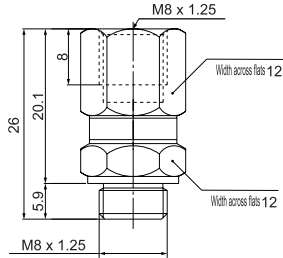

KZP2V-A01

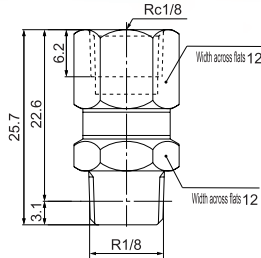

KZP2V-B5-

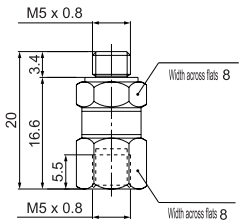

KZP2V-B8-

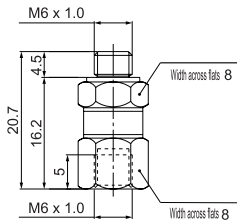

KZP2V-B01

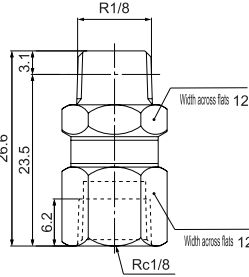

KZP2V-A5A5-

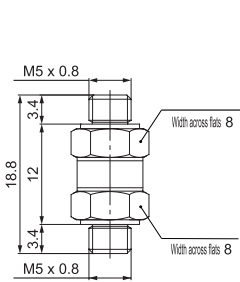

KZP2V-A01A01-

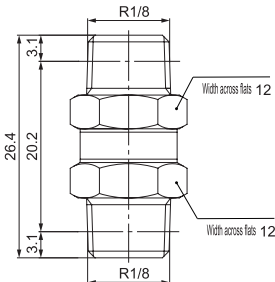

KZP2V-B5B5-

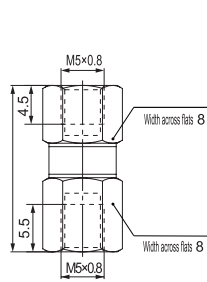

KZP2V-B01B01-

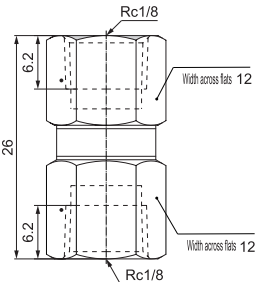

KZP2V-A5W4-

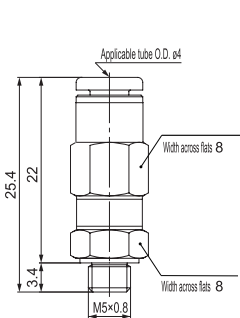

KZP2V-A01W6-

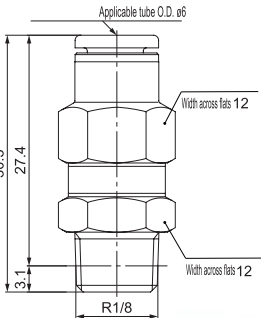

KZP2V-B5W4-

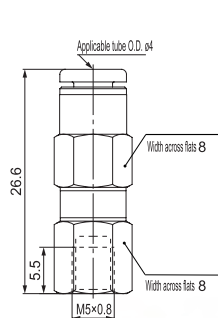

KZP2V-B01W6-

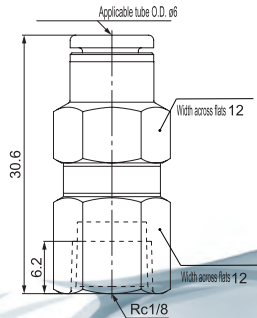

VACUUM SAVING VALVES

Application

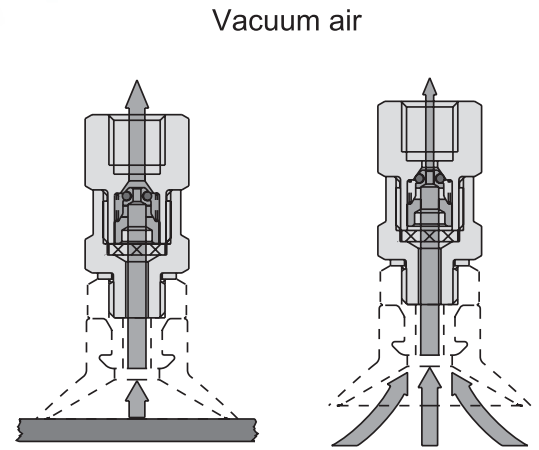
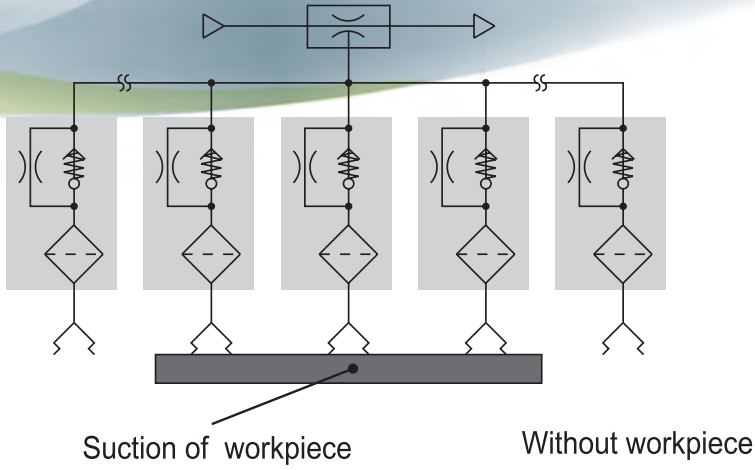

When working with lots of suction pads the Vacuum Saving Valves allow you to pick up different sized workpieces. When the workpiece comes into contact with the suction pad the internal valve opens and allows full vacuum on each pad that is in contact.