

316 Stainless Steel Twin Ferrule Imperial Tube Fittings

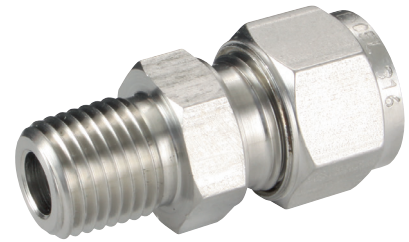

Male Connectors

Male Thread, NPT

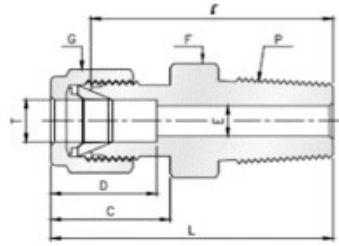

Part No	Tube O.D. T in	P (NPT)	E Min	F Inch	G Inch	D	C	I	L
MC-125-125N	1/8	1/8	2.28	7/16	7/16	12.70	15.24	23.87	30.48
MC-125-250N	1/8	1/4	2.28	9/16	7/16	12.70	15.24	28.95	35.56
MC-125-375N	1/8	3/8	2.28	11/16	7/16	12.70	15.24	29.21	35.81
MC-125-500N	1/8	1/2	2.28	7/8	7/16	12.70	15.24	35.56	42.16
MC-187-125N	3/16	1/8	3.04	7/16	1/2	13.71	16.00	24.63	31.24
MC-187-250N	3/16	1/4	3.04	9/16	1/2	13.71	16.00	29.71	36.32
MC-250-125N	1/4	1/8	4.82	1/2	9/16	15.24	17.78	25.40	32.76
MC-250-250N	1/4	1/4	4.82	9/16	9/16	15.24	17.78	30.48	37.84
MC-250-375N	1/4	3/8	4.82	11/16	9/16	15.24	17.78	30.98	38.35
MC-250-500N	1/4	1/2	4.82	7/8	9/16	15.24	17.78	37.33	44.70
MC-250-750N	1/4	3/8	4.82	11/16	9/16	15.24	17.78	30.98	38.35
MC-312-125N	5/16	1/8	4.82	9/16	5/8	16.25	18.54	26.67	34.03
MC-312-250N	5/16	1/4	6.35	9/16	5/8	16.25	18.54	31.24	38.60
MC-312-375N	5/16	3/8	6.35	11/16	5/8	16.25	18.54	31.75	39.11
MC-375-125N	3/8	1/8	4.82	5/8	11/16	16.76	19.30	29.94	35.30
MC-375-250N	3/8	1/4	7.11	5/8	11/16	16.76	19.30	32.51	39.87
MC-375-375N	3/8	3/8	7.11	11/16	11/16	16.76	19.30	32.51	39.87
MC-375-500N	3/8	1/2	7.11	7/8	11/16	16.76	19.30	38.86	46.22
MC-375-750N	3/8	3/4	7.11	1-1/16	11/16	16.76	19.30	40.38	47.75
MC-500-125N	1/2	1/8	4.82	13/16	7/8	22.86	21.84	28.70	38.86
MC-500-250N	1/2	1/4	7.11	13/16	7/8	22.86	21.84	33.27	43.43
MC-500-375N	1/2	3/8	9.65	13/16	7/8	22.86	21.84	33.27	43.43
MC-500-500N	1/2	1/2	10.41	7/8	7/8	22.86	21.84	38.86	49.02
MC-500-750N	1/2	3/4	10.41	1-1/16	7/8	22.86	21.84	40.38	50.54
MC-500-1000N	1/2	1	10.41	1-3/8	7/8	22.86	21.84	46.99	57.15
MC-625-375N	5/8	3/8	9.65	15/16	1	24.38	21.84	34.03	44.19
MC-625-500N	5/8	1/2	11.93	15/16	1	24.38	21.84	38.86	49.02
MC-625-750N	5/8	3/4	12.70	1-1/16	1	24.38	21.84	40.38	50.54
MC-750-500N	3/4	1/2	11.93	1-1/16	1-1/8	24.38	21.84	40.38	50.54
MC-750-750N	3/4	3/4	15.74	1-1/16	1-1/8	24.38	21.84	40.38	50.54
MC-750-1000N	3/4	1	15.74	1-3/8	1-1/8	24.38	21.84	46.99	57.15
MC-875-750N	7/8	3/4	15.74	1-3/16	1-1/4	25.90	21.84	40.38	50.54
MC-875-1000N	7/8	1	18.28	1-3/8	1-1/4	25.90	21.84	46.99	57.15
MC-1000-500N	1	1/2	11.93	1-3/8	1-1/2	31.24	26.41	45.21	57.40
MC-1000-750N	1	3/4	15.74	1-3/8	1-1/2	31.24	26.41	45.21	57.40
MC-1000-1000N	1	1	22.35	1-3/8	1-1/2	31.24	26.41	50.03	62.23