

316 Stainless Steel DIN 2353 Tube Fittings

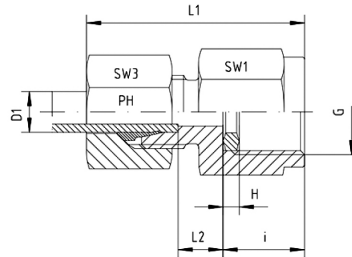

Rubrik 8.163 BSP - Parallel - Standard



- Gauge Couplings
- With Metal Sealing Ring - DKRi
- Internal Thread: BSP - Female - Parallel

Series L									
Pressure	Tube O.D.	Thread	Approx. Dimensions						Art.No.
PN	D1	G	H	L1	L2	I	SW1	SW3	
315	6	G 1/4"	4,5	37,0	7,5	14,5	19	14	MV-L-06-G 1/4"
315	6	G 1/2"	5,0	46,0	9,0	20,0	27	14	MV-L-06-G 1/2"
315	8	G 1/4"	4,5	37,0	7,5	14,5	19	17	MV-L-08-G 1/4"
315	8	G 1/2"	5,0	46,0	9,0	20,0	27	17	MV-L-08-G 1/2"
315	10	G 1/4"	4,5	38,0	8,5	14,5	19	19	MV-L-10-G 1/4"
315	10	G 1/2"	5,0	47,0	9,5	20,0	27	19	MV-L-10-G 1/2"
315	12	G 1/4"	4,5	38,0	8,5	14,5	19	22	MV-L-12-G 1/4"
315	12	G 1/2"	5,0	48,0	10,0	20,0	27	22	MV-L-12-G 1/2"



Series S									
Pressure	Tube O.D.	Thread	Approx. Dimensions						Art.No.
PN	D1	G	L1	L2	SW1	SW2	SW3		
630	6	G 1/2"	5,0	46,0	11,0	20,0	27		MV-S-06-G 1/2"
630	8	G 1/4"	4,5	40,0	9,5	14,5	19		MV-S-08-G 1/4"
630	8	G 1/2"	5,0	46,0	11,0	20,0	27		MV-S-08-G 1/2"
630	10	G 1/4"	4,5	40,5	9,0	14,5	19		MV-S-10-G 1/4"
630	10	G 1/2"	5,0	47,0	10,5	20,0	27		MV-S-10-G 1/2"
630	12	G 1/4"	4,5	41,0	8,0	14,5	22		MV-S-12-G 1/4"
630	12	G 1/2"	5,0	47,0	10,5	20,0	27		MV-S-12-G 1/2"

