

Storz DIN Suction Couplings

Hose Tails

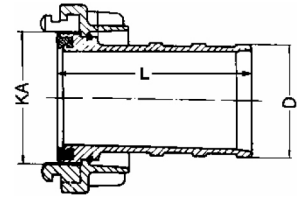
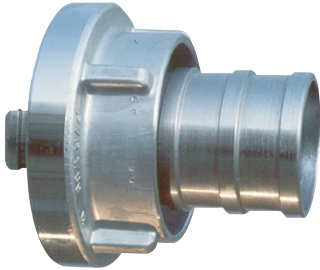

Materials:

Body: aluminium light alloy

Seal: nitrile rubber black / white

Storz Size	KA Lug (mm)	D Diameter (mm)	L Length (mm)	Weight (kg)	Comment	Part Code
25-D	31	25	53	0.09	DIN 14 301	SZ-12-031025-10
32	44	19	70	0.14		SZ-12-044019-10
32	44	25	70	0.14		SZ-12-044025-10
32	44	32	70	0.14		SZ-12-044032-10
38	51	38	90	0.22		SZ-12-051038-10
52-C	66	25	90	0.37		SZ-12-066025-10
52-C	66	32	90	0.37		SZ-12-066032-10
52-C	66	45	90	0.37		SZ-12-066045-10
52-C	66	52	90	0.37	DIN 14 321	SZ-12-066052-10
52-C	66	60	90	0.40		SZ-12-066060-10
65	81	65	95	0.51		SZ-12-081065-10
75-B	89	65	125	0.68		SZ-12-089065-10
75-B	89	70	125	0.73		SZ-12-089070-10
75-B	89	75	125	0.71	DIN 14 322	SZ-12-089075-10
75-B	89	80	125	0.77		SZ-12-089080-10
90	105	90	160	1.09		SZ-12-105090-10
100	115	100	150	1.15		SZ-12-115100-10
110-A	133	100	170	1.77		SZ-12-133100-10
110-A	133	110	170	1.66	DIN 14 323	SZ-12-133110-10
150	160	150	180	2.90		SZ-12-160150-10
205	220	205	375	7.20	Max. PN 10	SZ-12-220205-10