

Storz DIN Suction Couplings Adaptors

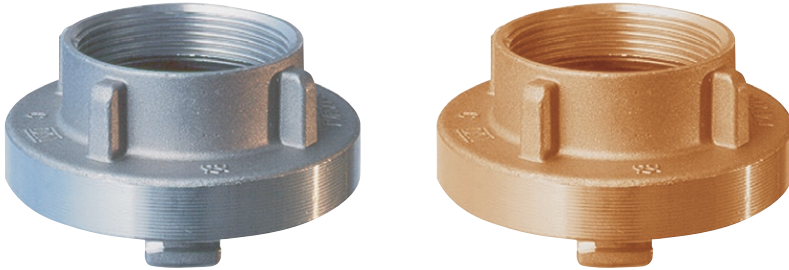

Materials:

Body: aluminium light alloy.

Seal: nitrile rubber, black / white.

Storz Size	KA Lug (mm)	Female Thread	Weight (kg)	Comment	Part Code
25-D	31	1/2"	0.08		SZ-21-031050-10
25-D	31	3/4"	0.08		SZ-21-031075-10
25-D	31	1"	0.08	DIN 14 306	SZ-21-031100-10
32	44	1"	0.16		SZ-21-044100-10
32	44	1.1/4"	0.14		SZ-21-044125-10
38	51	1.1/2"	0.15		SZ-21-051150-10
38	51	2"	0.18		SZ-21-051200-10
52-C	66	1"	0.28		SZ-21-066100-15
52-C	66	1.1/2"	0.28		SZ-21-066150-15
52-C	66	2"	0.28	DIN 14 307	SZ-21-066200-15
52-C	66	2.1/2"	0.28		SZ-21-066250-15
65	81	2"	0.38		SZ-21-081200-10
65	81	2.1/2"	0.38		SZ-21-081250-10
75-B	89	2"	0.42		SZ-21-089200-15
75-B	89	2.1/2"	0.42	DIN 14 308	SZ-21-089250-15
75-B	89	3"	0.42		SZ-21-089300-15
90	105	3"	0.60		SZ-21-105300-10
100	115	4"	0.85		SZ-21-115400-10
110-A	133	4"	1.09		SZ-21-133400-10
110-A	133	4.1/2"	1.12	DIN 14 309	SZ-21-133450-10
205	220	8"	3.48	Max. PN 10 bar	SZ-21-220800-10

Materials:

Body: copper alloy.

Seal: nitrile rubber, black / white.

Storz Size	KA Lug (mm)	Female Thread	Weight (kg)	Comment	Part Code
25-D	31	1"	0.23		SZ-21-031100-30
38	51	2"	0.53		SZ-21-051200-30
52-C	66	2"	0.80	DIN 86 204	SZ-21-066200-35
52-C	66	2.1/2"	0.90		SZ-21-066250-30
65	81	2"	1.47		SZ-21-081200-30